



FORD FAIRLANE & TORINO RESTORATION PARTS



SilentDrivePRO SOUND DAMPENING



AMD's new SilentDrive Pro Mat Sound Deadener offers premium noise reduction with three different versions to suit various needs. Two of the variants feature a 2mm thickness, with one showcasing blue lettering and the other white lettering for aesthetic preferences. For those seeking enhanced sound insulation, a thicker 7mm option is available. Each box includes 10 sheets, covering a total of 43 square feet, making it an excellent solution for reducing vibrations and road noise in vehicles or other applications requiring soundproofing.



403-1000-825B



403-1000-857

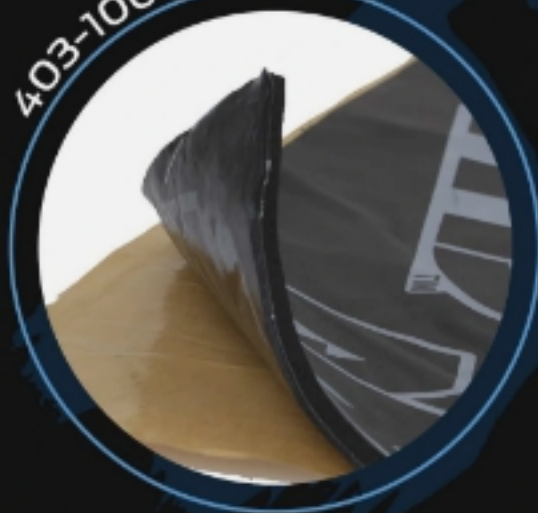



INDEX

66-67 FAIRLANE



After years of only offering the small-block 221, 260, or 289 V8 (except for the very limited edition thunderbolt and Comet AF/X drag cars), Ford and Mercury finally designed the Fairlane, Comet, and Cyclone to accept the big-block FF, 390 V8. In '66, all GT models had the 390 ci 335 hp V8 as standard equipment. A very few '66 Fairlane GT's could have the 289 V8 as well as the 390 or 427 V8, and '67 comets could

have the 427 V8 as well (very rare cars!). The Ranchero switched to the Fairlane platform for the first time in '67.

68-69 FAIRLANE/TORINO

For '68 the Torino and Cyclone offered a sleek fastbak roof line that added top end speed on the NASCAR tracks. Dodge responded in '69 with the special Charger 500 models with a sleek front end and a fiberglass plug filling in the back window, so Ford and Mercury responded with the awesome '69 Talladega and Cyclone Spoiler II with their own flush front end styling, which then prompted Dodge to craft the wild Charger Daytona with aero front end and wild rear wing.



On the street, the 427 V8 was detuned to 390 hp but only available with automatic 428 Cobra Jet rated at a detuned 335hp. In '69, the high performance Torino Cobra and Cyclone CJ 428 were first offered.

70-71 TORINO



In '70, the 429 Cobra-Jet was offered with or without Ram Air, and the awesome Drag Pack was available which turned them into the 427 Super Cobra-Jet. Cobra and Spoiler models were continued. This was the pinnacle of Ford Mid-Size Performance!

Description	Page
Back Glass	30
Bumper Bracket	2
Cowl	10
Crossrail	26
Deck Filler	20
Deck Lid	23
Door	17
Door Glass	31
Door Jamb	19
Fender	4
Fender to Radiator Support	5
Firewall	12
Floor Pan	12
Frame Rail	26
Front Bumper	2
Gas Tank	29
Grille Support	5
Grille to Bumper Filler	2
Hardware	35
Headlamp	4
Hood	7
Inner Fender	6
License Plate	3
Quarter Glass	31
Quarter Panel	22
Radiator Support	9
Rear Bumper	3
Rocker Panel	16
Spare Tire	23
Sunvisor	19
Tail Lamp	27
Trunk Extension	24
Trunk Gutter	25
Trunk Lock	23
Vent Glass	31
Vent Window Handle	31
Wheelhouse	21
Window Crank Handle	32
Windshield	30

FRONT BUMPERS



1



2



3



4



6



7



8



VISIT US ONLINE FOR THE MOST UP-TO-DATE PRICING AND SELECTION

#	YEAR	DESCRIPTION	MODEL	PART #
1	66-67	Front Bumper	Fairlane, Ranchero	100-8466
2	68-69	Front Bumper	Fairlane, Torino, Ranchero	100-8468
3	70-71	Front Bumper	Fairlane, Torino, Falcon, Ranchero	100-8470
4	62-63	Front Bumper	Falcon, Ranchero	100-8062
5	64-65	Front Bumper	Falcon, Ranchero	100-8064
6	66-67	Front Bumper Bolt Kit - 28 pcs	Fairlane, Ranchero	101-8466-S
7	68-69	Front Bumper Bolt Kit - 38 pcs	Fairlane, Torino, Ranchero	101-8468-S
8	70-71	Front Bumper Bolt Kit - 32 pcs	Fairlane, Torino, Ranchero	101-8470-S



2



1



3

#	YEAR	DESCRIPTION	MODEL	PART #
1	66-67	Grille to Bumper Filler Panel	Fairlane, Ranchero	115-8466
	68-69	Grille to Bumper Filler Panel - Modify to fit '69	Fairlane, Torino	115-8468
2	66-67	Front Bumper to Fender Bracket - LH	Fairlane, Ranchero	105-8466-3L
	66-67	Front Bumper to Fender Bracket - RH	Fairlane, Ranchero	105-8466-3R
3	66-67	Front Bumper Bracket Set	Fairlane, Ranchero	105-8466-S
	68-69	Front Bumper Bracket Set	Fairlane, Torino, Ranchero	105-8468-S



FAIRLANE/TORINO



REAR BUMPERS



1



2



3

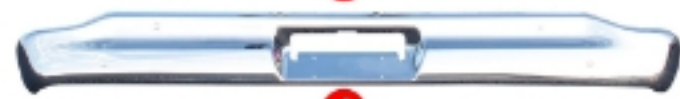

4



VISIT US ONLINE FOR THE MOST UP-TO-DATE PRICING AND SELECTION



6



7



8



9



10



11

#	YEAR	DESCRIPTION	MODEL	PART #
1	66-67	Rear Bumper	Fairlane	990-8466
2	68-69	Rear Bumper	Fairlane, Torino	990-8468
3	70-71	Rear Bumper	Torino	990-8470
4	60-63	Rear Bumper	Falcon	990-8060
5	64-65	Rear Bumper	Falcon	990-8064
6	66-67	Rear Bumper Bracket Set	Fairlane	970-8466-S
7	68-69	Rear Bumper Bracket Set - 4pcs	Fairlane, Torino	970-8468-S
8	66-67	Rear Bumper Filler - LH	Fairlane	975-8466-L
	66-67	Rear Bumper Filler - RH	Fairlane	975-8466-R
9	66-67	Rear Bumper Bolt Set - 24pcs	Fairlane, Ranchero	991-8466-S
10	68-69	Rear Bumper Bolt Set - 30pcs	Fairlane, Torino, Ranchero	991-8468-S
11	70-71	Rear Bumper Bolt Set - 24pcs	Torino, Ranchero	991-8470-S



1



2



3

#	YEAR	DESCRIPTION	MODEL	PART #
1	66-70	Front License Plate Bracket	Fairlane, Ranchero, Falcon	102-8466
2	68-69	Front License Plate Bracket	Fairlane, Torino, Ranchero	102-8468
3	70-71	Front and Rear License Plate Hardware Kit - 4 pcs	Fairlane, Torino, Ranchero	X102-4568-S





2



1

HEADLAMP



3

4

5

VISIT US ONLINE FOR THE MOST UP-TO-DATE PRICING AND SELECTION



#	YEAR	DESCRIPTION	MODEL	PART #
1	67	Headlamp Brace - LH	Fairlane, Ranchero	202-8467-L
	67	Headlamp Brace - RH	Fairlane, Ranchero	202-8467-R
2	68-69	Headlamp Mounting Ring - LH	Fairlane, Torino, Ranchero	X141-8468-2L
	68-69	Headlamp Mounting Ring - RH	Fairlane, Torino, Ranchero	X141-8468-2R
	70-71	Headlamp Mounting Ring - LH	Fairlane, Ranchero	X141-8968-1
	70-71	Headlamp Mounting Ring - RH	Fairlane	X141-8968-2
3	66-67	Headlamp Adjuster Set - 20 pcs	Fairlane, Ranchero	X142-8466-S
4	68-69	Headlamp Adjuster Set - 20 pcs	Fairlane, Torino, Ranchero	X142-8468-S
5	70-71	Headlamp Adjuster Set - 28 pcs	Torino, Ranchero	X142-8470-S

FENDERS



Stamped from high quality OE gauge steel on our exclusive new tools. Each fenders features the correct shape, size, bends, welds, curves and body lines, like original. Fenders arrive EDP coated to help protect against rust and corrosion.

LH = driver side - RH = passenger side

#	YEAR	DESCRIPTION	MODEL	PART #
1	66-67	Front Fender - LH	Fairlane	200-8466-L
	66-67	Front Fender - RH	Fairlane	200-8466-R





FAIRLANE/TORINO



FENDERS



#	YEAR	DESCRIPTION	MODEL	PART #
1	66-67	Fender to Radiator Support Bracket - LH	Fairlane, Falcon, Ranchero	115-8466-L
	66-67	Fender to Radiator Support Bracket - RH	Fairlane, Falcon, Ranchero	115-8466-R
2	66-67	Fender to Radiator Support Brace - LH	Fairlane, Falcon, Ranchero	220-8466-L
	66-67	Fender to Radiator Support Brace - RH	Fairlane, Falcon, Ranchero	220-8466-R
3	68-69	Fender to Bumper Bracket Brace - LH or RH	Fairlane, Torino	220-8468-1
4	68-69	Fender Eyebrow Moldings - Pair	Fairlane, Torino, Ranchero	X148-8468-1P
5	66-67	Lower Rear Fender Brace - LH or RH	Fairlane, Falcon, Ranchero	220-8466-2
	68-69	Lower Rear Fender Brace - LH or RH	Fairlane, Torino, Falcon, Ranchero	220-8468
6	66	Fender Apron to Dash Braces - Applicable for 67-69	Fairlane	260-8466-S



#	YEAR	DESCRIPTION	MODEL	PART #
1	66	Upper Grille Support Bracket - LH or RH	Fairlane	151-8466
2	66	Grille Support Brace - LH	Fairlane	202-8466-L
	66	Grille Support Brace - RH	Fairlane	202-8466-R



FENDERS

COMMON RUST AREA UNDER THE BATTERY TRAY

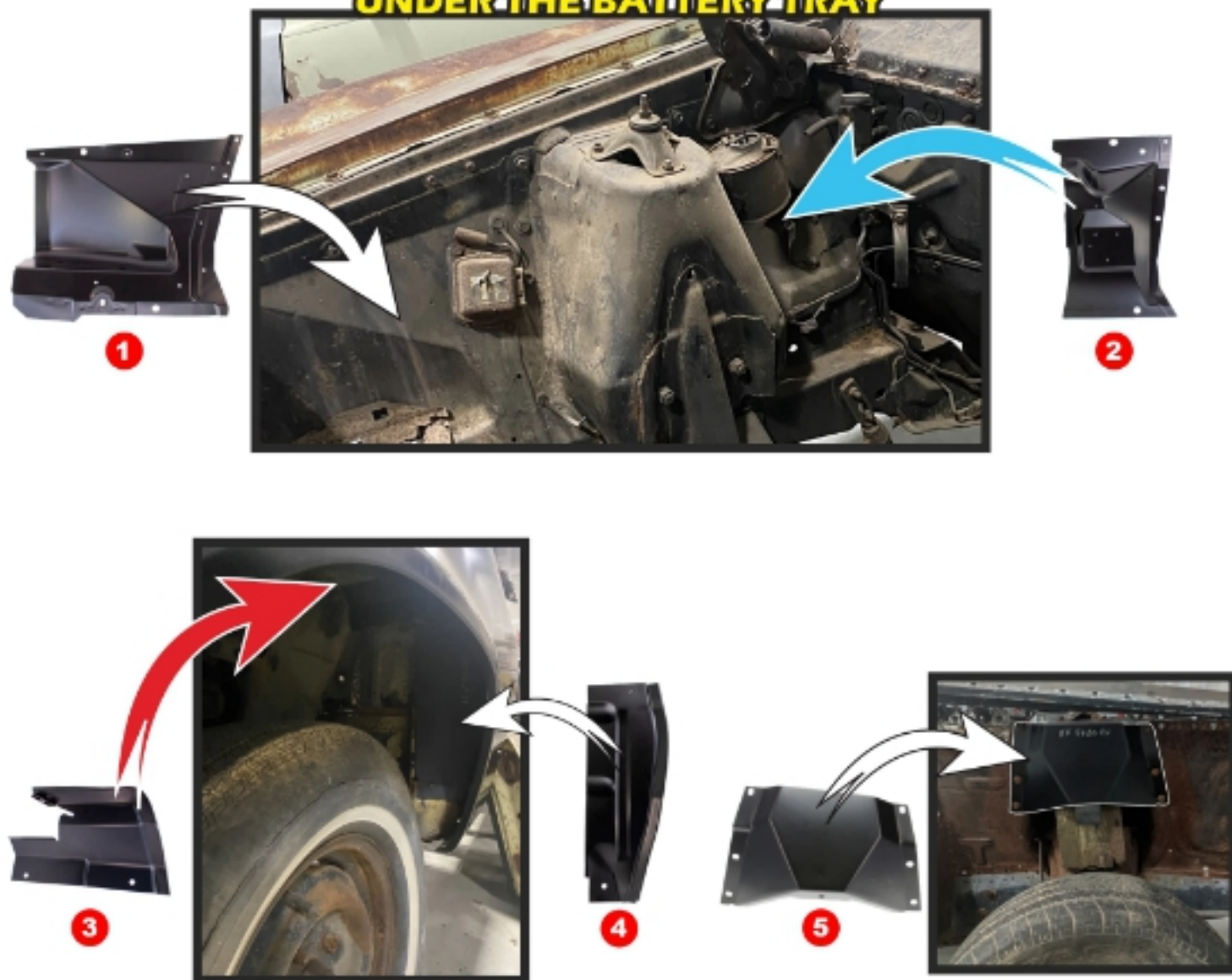

#	YEAR	DESCRIPTION	MODEL	PART #
1	66-69	Inner Fender - Front - LH	Fairlane, Torino, Rancho	250-8466-1L
	66-69	Inner Fender - Front - RH	Fairlane, Torino, Rancho	250-8466-1R
	70-71	Inner Fender - Front - LH	Fairlane, Torino, Rancho	250-8470-1L
	70-71	Inner Fender - Front - RH	Fairlane, Torino, Rancho	250-8470-1R
2	66-69	Inner Fender - Rear - LH	Fairlane, Torino, Rancho	250-8466-2L
	66-69	Inner Fender - Rear - RH	Fairlane, Torino, Rancho	250-8466-2R
	70-71	Inner Fender - Rear - LH	Fairlane, Torino, Rancho	250-8470-2L
	70-71	Inner Fender - Rear - RH	Fairlane, Torino, Rancho	250-8470-2R
3	66-67	Upper Rear Fender Splash Shield - LH	Fairlane, Rancho	255-8466-1L
	66-67	Upper Rear Fender Splash Shield - RH	Fairlane, Rancho	255-8466-1R
4	66-67	Lower Rear Fender Splash Shield - LH	Fairlane, Rancho	255-8466-L
	66-67	Lower Rear Fender Splash Shield - RH	Fairlane, Rancho	255-8466-R
5	66-71	Front Shock Tower Brace - LH	Fairlane, Torino, Falcon, Rancho	249-8466-1L
	66-71	Front Shock Tower Brace - RH	Fairlane, Torino, Falcon, Rancho	249-8466-1R



HOODS

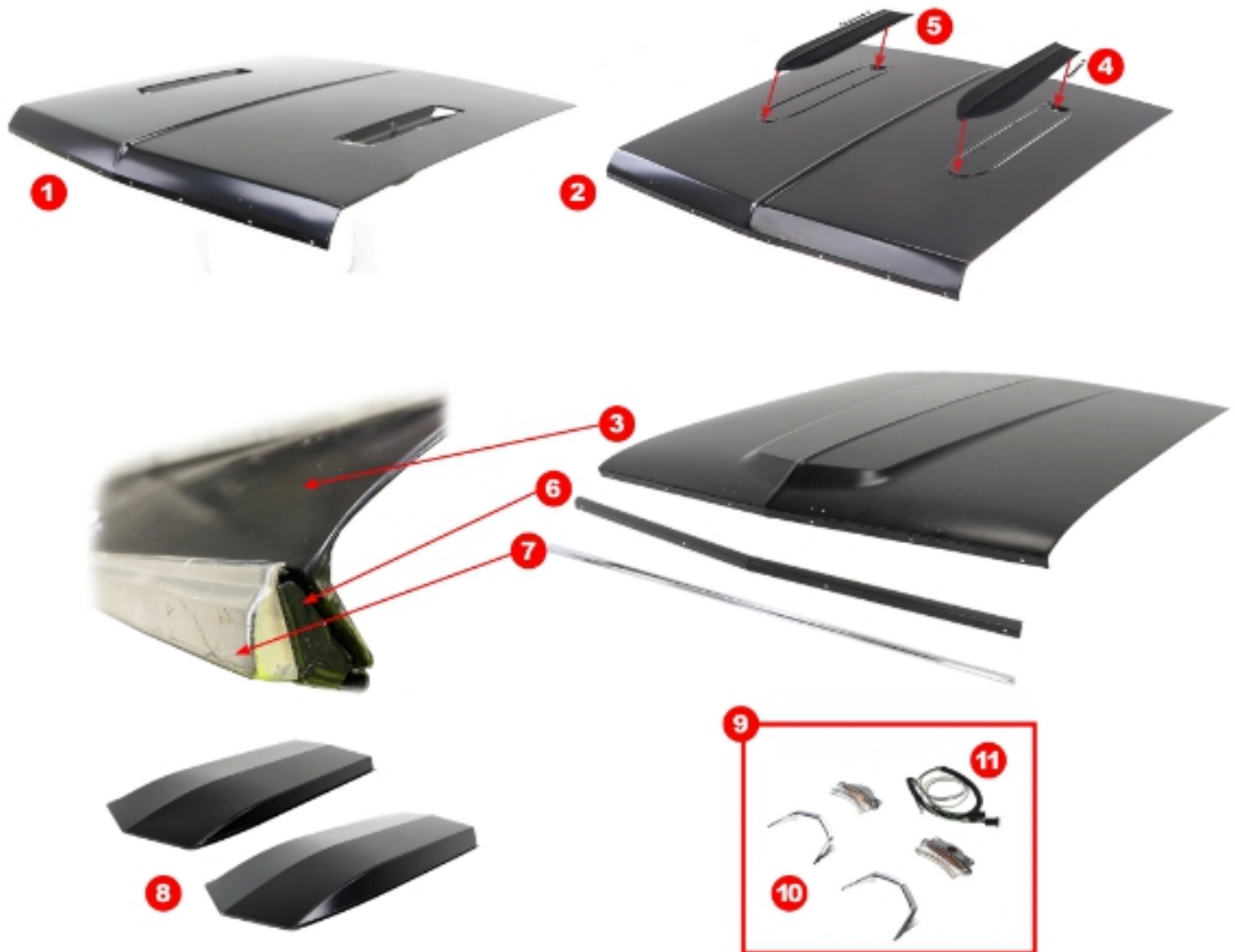

#	YEAR	DESCRIPTION	MODEL	PART #
1	66	Hood - GT Style	Fairlane	300-8466
2	67	Hood - GT Style	Fairlane	300-8467
3	68-69	Hood - OE Style	Fairlane, Torino	300-8468
4	67	Hood Insert - GT Style	Fairlane	320-8467-L
5	67	Hood Insert - GT Style	Fairlane	320-8467-R
6	68-69	Hood Lip Molding Mounting Strip	Fairlane, Torino	300-8468-1
7	68-69	Hood Lip Molding	Fairlane, Torino, Ranchero	X330-8468
8	66-72	Hood Scoop - 2" Raise - Universal	Fairlane, Torino, Falcon, Ranchero	301-SCOOP-1
	66-72	Hood Scoop - 4" Raise - Universal	Fairlane, Torino, Falcon, Ranchero	301-SCOOP-2
9	67	Hood Scoop Bezel & Lamp Assemblies - w/ Wiring Harness	Fairlane	E-67PDLFULLSET
10	67	Hood Scoop Bezels - Pair	Fairlane	E-67DBP
11	67	Hood Scoop Lamp Assembly - Pair	Fairlane	E-67PDLBODYSET
12	70-71	Shaker Hood Scoop Top Plug	Torino, Ranchero	E-D00ZPLUG
	70-71	Shaker Hood Scoop Cut-out Template	Torino, Ranchero	E-7071HKRTEMP

VISIT US ONLINE FOR THE MOST
 UP-TO-DATE PRICING AND SELECTION



HOODS

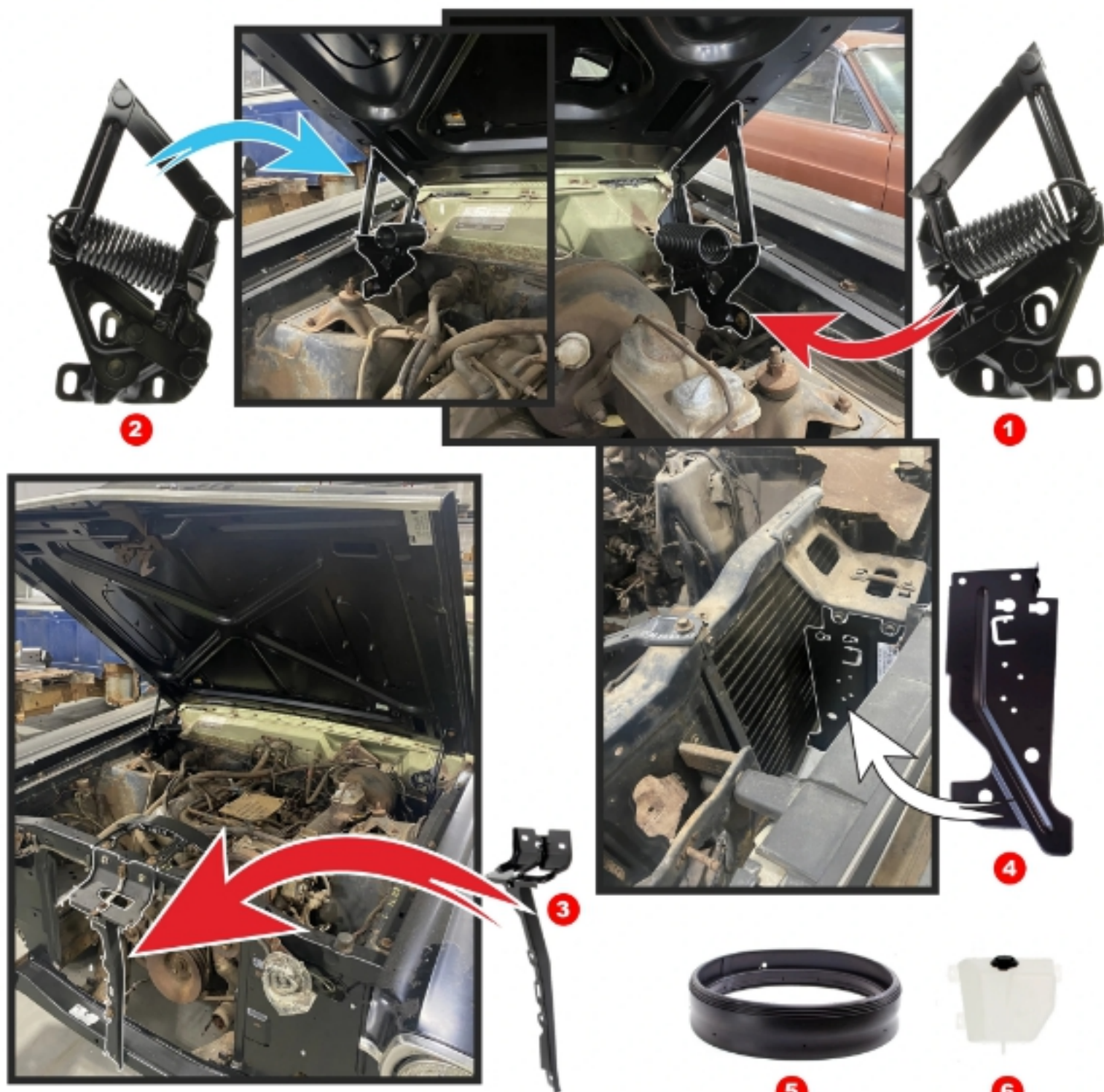

#	YEAR	DESCRIPTION	MODEL	PART #
1	66-69	Hood Hinges - Pair	Fairlane, Falcon, Ranchero	310-8466-L
2	68-69	Hood Hinges - Pair	Fairlane, Falcon, Ranchero	310-8466-R
3	66	Hood Latch Support	Fairlane, Ranchero	326-8466
	67-69	Hood Latch Support	Fairlane, Torino, Ranchero	326-8467
4	70-71	Hood Latch Support Brace - LH	Fairlane, Torino, Ranchero	326-8470-L
	70-71	Hood Latch Support Brace - RH	Fairlane, Torino, Ranchero	326-8470-R
5	69	Ram Air Seal	Fairlane, Torino	X334-8469
6	67-68	Windshield Washer Bottle & Cap	Fairlane, Torino, Falcon, Ranchero	X343-8466-S





FAIRLANE/TORINO



BATTERY

1



#	YEAR	DESCRIPTION	MODEL	PART #
1	66-69	Battery Hold Down Bracket	Fairlane, Torino	341-8961

RADIATOR SUPPORT



1



2



3



#	YEAR	DESCRIPTION	MODEL	PART #
1	66	Radiator Support - OE Style	Fairlane	350-8466
2	67	Radiator Support - OE Style	Fairlane, Rancho	350-8467
3	69	Radiator Support - OE Style	Fairlane, Torino, Rancho	350-8469



1



2



3



4



5



6



7

#	YEAR	DESCRIPTION	MODEL	PART #
1	70-71	Radiator Support Upper Bracket - LH	Torino, Rancho	350-8470-1L
	70-71	Radiator Support Upper Bracket - RH	Torino, Rancho	350-8470-1R
2	66	Lower Radiator Support Mounting Bracket - Pair	Fairlane	351-8466-1
	67	Lower Radiator Support Mounting Bracket - Pair	Fairlane	351-8467-2
3	67-69	Upper Radiator Mounting Bracket	Fairlane, Torino, Rancho	351-8467-3
4	68-69	Radiator Support to Fender Brace - LH	Fairlane, Torino	349-8468-L
	68-69	Radiator Support to Fender Brace - RH	Fairlane, Torino	349-8468-R
5	67-69	Radiator Cap - OE Style - Chrome	Fairlane, Torino, Falcon, Rancho	X357-1060-C
	67-69	Radiator Cap - OE Style - Zinc	Fairlane, Torino, Falcon, Rancho	X357-1060-Z
	67-69	Radiator Cap - OE Style - Chrome	Fairlane, Torino, Falcon, Rancho	X357-8467-C
	67-69	Radiator Cap - OE Style - Zinc	Fairlane, Torino, Falcon, Rancho	X357-8467-Z
6	66-69	Radiator Support Crossmember - Lower	Fairlane, Torino, Rancho	351-8466
7	65-72	Radiator Drain Petcock - 1/4" NPT	Fairlane, Torino, Falcon, Rancho	X347-405B-3



COWL



#	YEAR	DESCRIPTION	MODEL	PART #
1	66-67	Upper Cowl	Fairlane, Falcon, Rancho	360-8466
	68-69	Upper Cowl	Fairlane, Torino, Rancho	360-8468
	70-71	Upper Cowl Plenum	Torino	360-8470
2	66-67	Lower Cowl Panel	Fairlane, Falcon, Rancho	360-8466-1
	68-69	Lower Cowl Panel Plenum	Fairlane, Torino, Falcon, Rancho	360-8468-1
	70-71	Lower Cowl Plenum	Torino	360-8470-1
3	66-67	Windshield Corner Bracket - LH	Fairlane, Falcon, Rancho	360-8466-1L
	66-67	Windshield Corner Bracket - RH	Fairlane, Falcon, Rancho	360-8466-1R
4	66-69	Upper Cowl Lower Bracket - LH	Fairlane, Torino	360-8466-2L
5	66-67	Inner Cowl Side Extension - LH	Fairlane, Rancho	360-8466-L
	66-67	Inner Cowl Side Extension - RH	Fairlane, Rancho	360-8466-R
6	68-71	Upper Cowl to Inner Fender Brace - LH	Fairlane, Torino, Falcon, Rancho	360-8468-L
	68-71	Upper Cowl to Inner Fender Brace - RH	Fairlane, Torino, Falcon, Rancho	360-8468-R



VISIT US ONLINE FOR THE MOST UP-TO-DATE PRICING AND SELECTION





COWL



THE LOWER COWL IS A COMMON RUST AREA

Reproduction upper & lower cowl panel for 66-67, & 68-69 Ford Fairlane, Falcon & Ranchero and 66-67 Mercury Comet & Cyclone.

The lower cowl is a common area for water to collect and rust out over time. This is a needed replacement on almost every Fairlane.

Made like OE. Each piece is stamped from high quality OE gauge steel on our exclusive new tools and features the correct shape, size, bends and holes, like original. EDP coated to help protect against rust and corrosion.



2

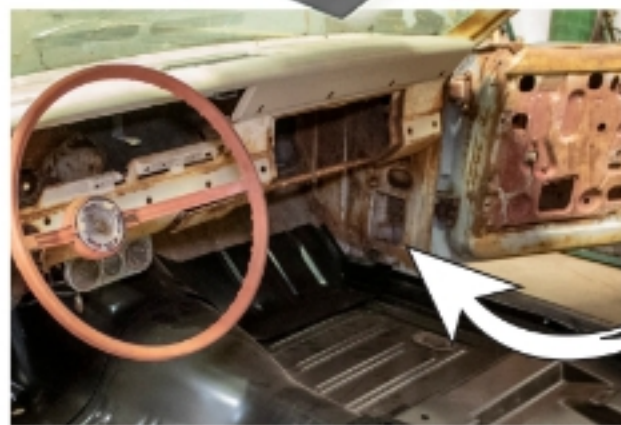

7



8



VISIT US ONLINE FOR THE MOST UP-TO-DATE PRICING AND SELECTION



#	YEAR	DESCRIPTION	MODEL	PART #
7	66-67	Inner Cowl Side Assembly - LH	Fairlane	376-8466-L
	66-67	Inner Cowl Side Assembly - RH	Fairlane	376-8466-R
	68-69	Inner Cowl Side Assembly - LH	Fairlane, Torino	376-8468-L
	68-69	Inner Cowl Side Assembly - RH	Fairlane, Torino	376-8468-R
8	67	Lower Door Hinge Pillar - LH	Fairlane, Ranchero	376-8466-1L
	67	Lower Door Hinge Pillar - RH	Fairlane, Ranchero	376-8466-1R



FIREWALL



#	YEAR	DESCRIPTION	MODEL	PART #
1	66-67	Firewall	Fairlane, Falcon, Ranchero	370-8466
	68-69	Firewall	Fairlane, Torino, Ranchero	370-8468
2	66-71	Lower Firewall Toe Board Patch - May Require Modification	Fairlane, Torino	370-8466-1

FLOOR PAN

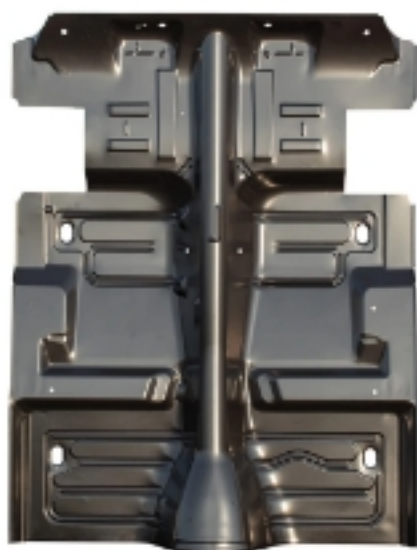

#	YEAR	DESCRIPTION	MODEL	PART #
3	66-71	Floor Pan - OE Style	Fairlane, Torino	400-8466

Please note: Our panel is correct for models equipped with wide spaced speedometer and emergency brake cables. Models with narrow spaced cables will require the speedometer cable holes to be filled and relocated. Please refer to the alternate product images to determine which version you have.



VISIT US ONLINE FOR THE MOST UP-TO-DATE PRICING AND SELECTION



FLOOR PAN

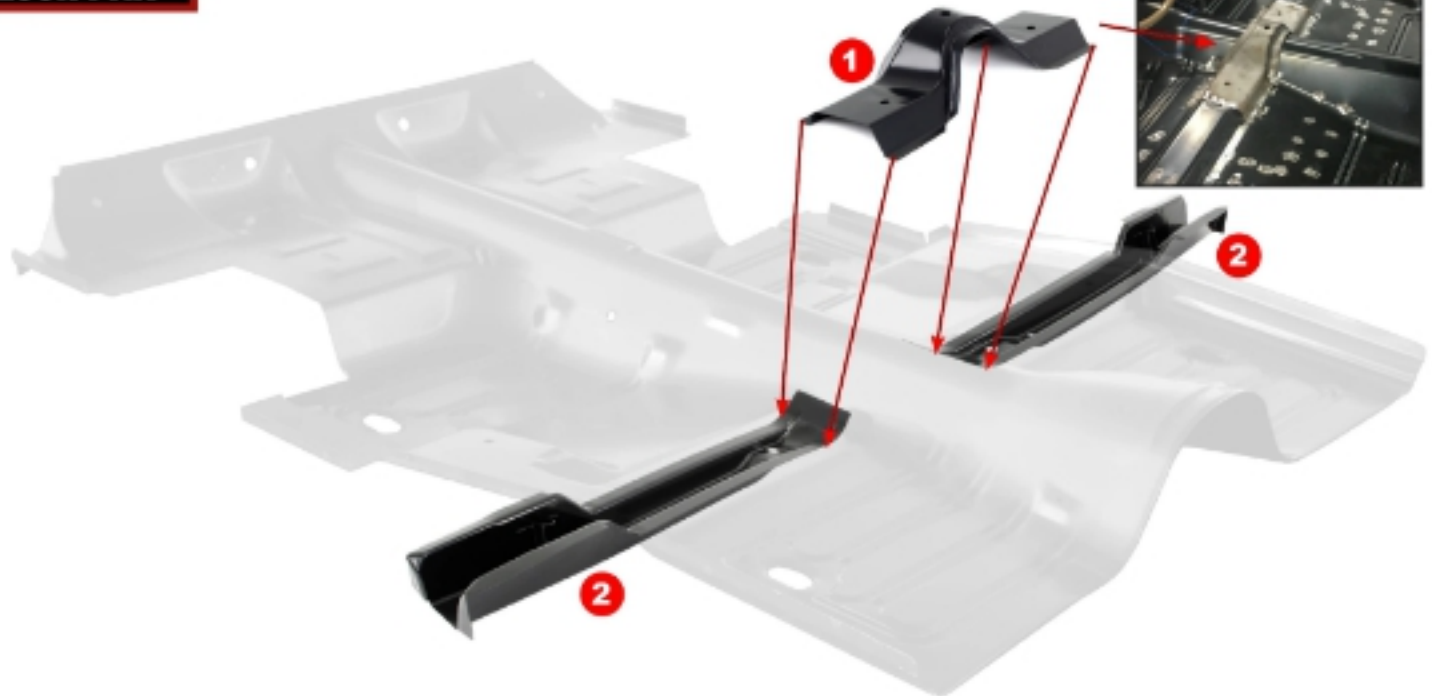

#	YEAR	DESCRIPTION	MODEL	PART #
1	66-71	Bucket Seat Floor Support/Bracket - (66-71 FAIRLANE 68-71 TORINO)	Fairlane, Torino, Rancho	407-8466
2	66-71	Center Floor Pan Brace - w/ Seat Anchor - LH	Fairlane, Torino, Rancho	407-8466-2L
	66-71	Center Floor Pan Brace - w/ Seat Anchor - RH	Fairlane, Torino, Falcon, Rancho	407-8466-2R
3	68-69	Front Floor Pan Brace - LH or RH	Fairlane, Torino, Falcon, Rancho	425-8468-1
4	66-71	Front Seat Floor Pan Brace - LH	Fairlane, Torino, Falcon, Rancho	407-8466-1L
	66-71	Front Seat Floor Pan Brace - RH	Fairlane, Torino, Falcon, Rancho	407-8466-1R
5	66-69	Front Crossmember Lower Reinforcement - Jack Pad	Fairlane, Torino	394-8466-1
6	66-69	Transmission Crossmember Support - LH	Fairlane	439-8466-10L
	66-69	Transmission Crossmember Support - RH	Fairlane	439-8466-10R



FLOOR PAN



1



2



3



4



5



6



7



8



9



10



VISIT US ONLINE FOR THE MOST UP-TO-DATE PRICING AND SELECTION



#	YEAR	DESCRIPTION	MODEL	PART #
1	62-66	Seat Belt Anchor to Floor Pan Reinforcements - 4pcs	Fairlane, Falcon, Ranchero	407-8963-1S
2	66-71	Floor Pan Park Brake Cable Retainer Bracket - LH	Fairlane, Torino, Falcon, Ranchero	425-8466
3	66-71	Floor Pan Rear Seat Back Support Brackets - 2pcs	Fairlane, Torino, Falcon	425-8466-2P
4	67-70	Seat Belt Anchor to Floor Pan Reinforcements - 2pcs	Fairlane, Torino, Falcon, Ranchero	425-8466-1P
5	66-71	Floor Pan Park Brake Cable J-Hook Bracket - RH	Fairlane, Torino, Falcon, Ranchero	425-8466-2
6	66-69	Side Floor to Rear Seat Pan Bracket - LH or RH	Fairlane, Torino, Falcon, Ranchero	425-8466-3
7	66-69	Rear Seat Attach Bracket Set - 2pcs	Fairlane, Torino	425-8466-P
8	66-69	Floor Pan Plug	Fairlane, Torino, Ranchero	427-8963
9	66-71	Shifter Tunnel Hump - Auto Transmission	Fairlane, Torino, Ranchero	415-8466-A
	66-69	Shifter Tunnel Hump - Manual Transmission	Fairlane, Torino, Ranchero	415-8466-M
10	68-69	Rear Seat Base Perch - Pair	Fairlane, Torino	425-8468-1P



TORQUE BOX



#	YEAR	DESCRIPTION	MODEL	PART #
1	66-69	Torque Box Plate - Upper - LH	Fairlane	439-8466-1L
	66-69	Torque Box Plate - Upper - RH	Fairlane	439-8466-1R
2	66-69	Torque Box Plate - Lower - LH	Fairlane	439-8466-2L
	66-69	Torque Box Plate - Lower - RH	Fairlane	439-8466-2R
3	66-69	Torque Box Plate - Inner - LH	Fairlane	439-8466-3L
	66-69	Torque Box Plate - Inner - RH	Fairlane	439-8466-3R
4	66-69	Torque Box Plate - Outer - LH	Fairlane	439-8466-9L
	66-69	Torque Box Plate - Outer - RH	Fairlane	439-8466-9R
5	66-67	Torque Box Plate - Inner Cover	Fairlane	395-8466-11
6	68-69	Torque Box Plate - Reinforcement - Inner - LH	Fairlane	439-8468-4L
	68-69	Torque Box Plate - Reinforcement - Inner - RH	Fairlane	439-8468-4R
7	66-69	Torque Box Floor Pan Brace - Upper Rear - LH	Fairlane, Torino	425-8466-4L
	66-69	Torque Box Floor Pan Brace - Upper Rear - RH	Fairlane, Torino	425-8466-4R
8	66-69	Torque Box Floor Pan Brace - Lower Rear - LH	Fairlane, Rancho	425-8466-5L
	66-69	Torque Box Floor Pan Brace - Lower Rear - RH	Fairlane, Rancho	425-8466-5R
9	66-67	Torque Box Lower to Crossmember Support Gusset Plate - LH	Fairlane	439-8466-8L
	66-67	Torque Box Lower to Crossmember Support Gusset Plate - RH	Fairlane	439-8466-8R
10	68-69	Torque Box Lower to Crossmember Support Gusset Plate - LH	Fairlane	439-8468-7L
	68-69	Torque Box Lower to Crossmember Support Gusset Plate - RH	Fairlane	439-8468-7R
11	68-69	Torque Box Lower to Rocker Gusset Plate - LH	Fairlane	439-8468-5L
	68-69	Torque Box Lower to Rocker Gusset Plate - RH	Fairlane	439-8468-5R
12	68-69	Torque Box Lower to Subframe Gusset Plate - LH	Fairlane	439-8468-6L
	68-69	Torque Box Lower to Subframe Gusset Plate - RH	Fairlane	439-8468-6R



VISIT OUR WEBSITE FOR THE MOST UP-TO-DATE PRICING AND SELECTION



FLOOR PANEL



1



2



3



4

#	YEAR	DESCRIPTION	MODEL	PART #
1	62-66	Steering Column Collar	Fairlane, Falcon, Ranchero	458-8961-1
2	62-65	Ignition Switch Bezel	Fairlane, Falcon, Ranchero	X460-8061-1
2	64-65	Ignition Switch Spacer	Falcon, Ranchero	X460-8064-1
4	69-71	Console Arm Rest	Fairlane, Torino	X491-8469



1

Reproduction under rear seat floor panel for the 66-69 Fairlane Comet Cyclone & 68-69 Torino Montego.

Stamped from high quality heavy gauge steel on our exclusive new tools. Each panel features the correct shape, size, holes, bends and ribs, like original. Arrives EDP coated to help protect against rust and corrosion.

#	YEAR	DESCRIPTION	MODEL	PART #
1	66-69	Rear Floor Panel - Over the Aisle	Fairlane, Torino	420-8466



1

2

#	YEAR	DESCRIPTION	MODEL	PART #
1	66-69	Rocker Panel - Inner - LH	Fairlane, Torino	440-8466-L
1	66-69	Rocker Panel - Inner - RH	Fairlane, Torino	440-8466-R
2	66-67	Rocker Panel End Cap - LH	Fairlane	451-8466-L
2	66-67	Rocker Panel End Cap - RH	Fairlane	451-8466-R



VISIT US ONLINE FOR THE MOST UP-TO-DATE PRICING AND SELECTION





DOOR



#	YEAR	DESCRIPTION	MODEL	PART
1	66-67	Door Shell - LH	Fairlane	500-8466-L
	66-67	Door Shell - RH	Fairlane	500-8466-R



#	YEAR	DESCRIPTION	MODEL	PART
2	66-69	Door Hinge - Upper - LH	Fairlane, Torino, Falcon, Ranchero	520-8466-L
	66-69	Door Hinge - Upper - RH	Fairlane, Torino, Falcon, Ranchero	520-8466-R
	66-69	Door Hinge - Lower - LH	Fairlane, Torino, Falcon, Ranchero	525-8466-L
	66-69	Door Hinge - Lower - RH	Fairlane, Torino, Falcon, Ranchero	525-8466-R



#	YEAR	DESCRIPTION	MODEL	PART
3	66-67	Door Handle - Interior - LH or RH	Fairlane, Falcon, Ranchero	X540-8066
4	68-69	Door Handle - Interior - Front - LH	Fairlane, Torino, Falcon, Ranchero	X540-4568-L
	68-69	Door Handle - Interior - Front - RH	Fairlane, Torino, Falcon, Ranchero	X540-4568-R
5	68-69	Door Handle Cup - Black - LH or RH	Fairlane, Torino, Falcon, Ranchero	X540-4568-I
6	66-67	Door Handle Remote - Interior - LH	Fairlane, Falcon	X540-8467-L
6	66-67	Door Handle Remote - Interior - RH	Fairlane, Falcon	X540-8467-R
7	73-76	Door Handle - Outside - LH	Torino, Ranchero	X530-4573-L
	73-76	Door Handle - Outside - RH	Torino, Ranchero	X530-4573-R



VISIT US ONLINE FOR THE MOST UP-TO-DATE PRICING AND SELECTION

DOOR



1



2



3



4



5



6

#	YEAR	DESCRIPTION	MODEL	PART #
1	62-64	Door Latch Assembly - LH	Fairlane, Falcon, Ranchero	X535-8462-L
	62-64	Door Latch Assembly - RH	Fairlane, Falcon, Ranchero	X535-8462-R
2	65	Door Latch - LH	Fairlane	X535-8564-L
	65	Door Latch - RH	Fairlane	X535-8564-R
3	67	Door Latch - w/o Door Warning Light - LH	Fairlane, Falcon, Ranchero	X535-8567-L
	67	Door Latch - w/o Door Warning Light - RH	Fairlane, Falcon, Ranchero	X535-8567-R
4	68-70	Door Latch - w/o Door Warning Light or Vacuum Door Lock - LH	Fairlane, Torino, Falcon, Ranchero	X535-8568-L
	68-70	Door Latch - w/o Door Warning Light or Vacuum Door Lock - RH	Fairlane, Torino, Falcon, Ranchero	X535-8568-R
5	71-76	Door Latch - LH	Torino, Ranchero	X535-8571-L
	71-76	Door Latch - RH	Torino, Ranchero	X535-8571-R
6	73-79	Door Latch Control - LH	Torino, Ranchero	X535-4573-L
	73-79	Door Latch Control - RH	Torino, Ranchero	X535-4573-R



7



8

#	YEAR	DESCRIPTION	MODEL	PART #
7	64-66	Rear View Mirror Set - Outside - RH Manual Match for LH Remote Chrome - w/ gasket and screws	Fairlane, Falcon, Ranchero	X570-8064-RS
8	67-70	Rear View Mirror Set - Outside - Standard Chrome - w/ gasket and screws	Fairlane, Torino, Ranchero	X570-8067-S



9

#	YEAR	DESCRIPTION	MODEL	PART #
9	65	Door Lock Knobs - Chrome Pair	Fairlane, Falcon, Ranchero	X536-8065-P
	66-67	Door Lock Knobs - Chrome Pair	Fairlane, Falcon, Ranchero	X536-8965-P
	68-74	Door Lock Knobs - Chrome Pair	Fairlane, Torino, Falcon, Ranchero	X536-8068-P
	73-79	Door Lock Knobs - Chrome Pair	Fairlane, Torino, Falcon, Ranchero	536-4575-C

10



11



#	YEAR	DESCRIPTION	MODEL	PART #
10	63-65	Door Striker Set	Fairlane, Torino, Falcon, Ranchero	X752-8462-S
11	66-71	Door Striker Set	Fairlane, Torino, Falcon, Ranchero	X752-8965-S



VISIT US ONLINE FOR THE MOST UP-TO-DATE PRICING AND SELECTION



DOOR PILLAR



#	YEAR	DESCRIPTION	MODEL	PART
1	66-67	Door Jamb Lock Pillar - w/ Reinforcement - LH	Fairlane	750-8466-L
	66-67	Door Jamb Lock Pillar - w/ Reinforcement - RH	Fairlane	750-8466-R
2	68-69	Door Jamb Lock Pillar - w/ Reinforcement - LH	Fairlane, Torino	750-8468-L
	68-69	Door Jamb Lock Pillar - w/ Reinforcement - RH	Fairlane, Torino	750-8468-R



VISIT US ONLINE FOR THE MOST UP-TO-DATE PRICING AND SELECTION



#	YEAR	DESCRIPTION	MODEL	PART
1	69-75	Survivor Arm and Bracket - LH or RH	Fairlane, Torino, Falcon	X646-8069-1

DECK FILLER



#	YEAR	DESCRIPTION	MODEL	PART #
1	66-67	Deck Filler Panel	Fairlane	650-8466
2	66-67	Deck Filler Panel	Fairlane, Torino	650-8468
3	66-67	Deck Filler to Package Tray Bracket - LH	Fairlane	650-8466-L
	66-67	Deck Filler to Package Tray Bracket - RH	Fairlane	650-8466-R
4	66-67	Package Tray to Floor Support - LH	Fairlane	640-8466-1L
	66-67	Package Tray to Floor Support - RH	Fairlane	640-8466-1R
5	66-67	Package Tray Extension - LH	Fairlane	640-8466-L
	66-67	Package Tray Extension - RH	Fairlane	640-8466-R
6	66-67	Wheelhouse to Roof Support - LH	Fairlane	610-8466-L
	66-67	Wheelhouse to Roof Support - RH	Fairlane	610-8466-R
7	70-71	Wheelhouse to Roof Support Bracket - LH	Torino	762-8470-1L
	70-71	Wheelhouse to Roof Support Bracket - RH	Torino	762-8470-1R
8	66-67	Wheelhouse to Trunk Support Bracket - LH	Fairlane	762-8466-1L
	66-67	Wheelhouse to Trunk Support Bracket - RH	Fairlane	762-8466-1R



 VISIT US ONLINE FOR THE BEST
 BUY-TO-DATE PRICING AND SELECTION



FAIRLANE/TORINO



WHEELHOUSE



Reproduction inner rear wheelhouse for the 66-70 Ford Falcon, 66-69 Ford Fairlane 66-69 Ford Ranchero, 66-69 Mercury Comet, 66-69 Mercury Cyclone, 68-69 Ford Torino & 68-69 Mercury Montego. Correct for all models except Torino Talladega and station wagon.

Stamped from high quality heavy gauge steel on our exclusive new tools. Each wheelhouse features correct as original shape, size, bends, tabs and holes, like original. Wheelhouses arrive EDP coated to protect against rust and corrosion.

LH = Driver Side
RH = Passenger Side



VISIT US ONLINE FOR THE MOST UP-TO-DATE PRICING AND SELECTION

#	YEAR	DESCRIPTION	MODEL	PART #
1	66-69	Wheelhouse - Inner - LH	Fairlane, Torino, Ranchero	760-8466-L
	66-69	Wheelhouse - Inner - RH	Fairlane, Torino, Ranchero	760-8466-R
2	70-71	Wheelhouse - Inner - LH	Fairlane, Torino, Ranchero	760-8470-L
	70-71	Wheelhouse - Inner - RH	Fairlane, Torino, Ranchero	760-8470-R
3	66-67	Wheelhouse - Outer - LH	Fairlane	770-8466-L
	66-67	Wheelhouse - Outer - RH	Fairlane	770-8466-R
4	68-69	Wheelhouse - Outer - LH	Fairlane, Torino	770-8468-L
	68-69	Wheelhouse - Outer - RH	Fairlane, Torino	770-8468-R
5	70-71	Wheelhouse - Outer - LH	Fairlane, Torino	770-8470-L
	70-71	Wheelhouse - Outer - RH	Fairlane, Torino	770-8470-R





QUARTER PANEL



1



2



3



4



5



6



VISIT US ONLINE FOR THE MOST UP-TO-DATE PRICING AND SELECTION



#	YEAR	DESCRIPTION	MODEL	PART #
1	66	Quarter Panel - OE Style - LH	Fairlane	700-8466-L
	66	Quarter Panel - OE Style - RH	Fairlane	700-8466-R
2	67	Quarter Panel - OE Style - LH	Fairlane	700-8467-L
	67	Quarter Panel - OE Style - RH	Fairlane	700-8467-R
3	68	Quarter Panel - OE Style - LH	Fairlane, Torino	700-8468-L
	68	Quarter Panel - OE Style - RH	Fairlane, Torino	700-8468-R
4	69	Quarter Panel - OE Style - LH	Fairlane, Torino	700-8469-L
	69	Quarter Panel - OE Style - RH	Fairlane, Torino	700-8469-R
5	70	Quarter Panel - OE Style - LH	Torino	700-8470-L
	70	Quarter Panel - OE Style - RH	Torino	700-8470-R
6	70	Quarter Panel Hash Mark Ornament Set - 10pcs	Torino	E-70FBHASHMARKS



DECK LID



#	YEAR	DESCRIPTION	MODEL	PART #
1	68-69	Deck Lid	Fairlane, Torino	850-8468

SPARE TIRE



#	YEAR	DESCRIPTION	MODEL	PART #
1	66-67	Trunk Lock Support	Fairlane	810-8466
2	68-69	Trunk Lock Support	Fairlane, Torino	810-8468
3	70-71	Trunk Lock Support	Fairlane, Torino	810-8470
4	66-67	Spare Tire Retainer Hook & Wingnut	Fairlane	816-8466
5	66-71	Spare Tire Hold Down Bracket	Fairlane, Torino	817-8466
6	66-71	Spare Tire Hold Down Anchor	Fairlane, Torino	818-8466
7	66-67	Spare Tire Anchor	Fairlane	818-8466-1



VISIT US ONLINE FOR THE MOST UP-TO-DATE PRICING AND SELECTION



TRUNK EXTENSION



1

2

3



4

#	YEAR	DESCRIPTION	MODEL	PART #
1	66-67	Trunk Floor Side Extension - LH	Fairlane	840-8466-L
	66-67	Trunk Floor Side Extension - RH	Fairlane	840-8466-R
2	68-69	Trunk Floor Side Extension - LH	Fairlane, Torino	840-8468-L
	68-69	Trunk Floor Side Extension - RH	Fairlane, Torino	840-8468-R
3	70-71	Trunk Floor Side Extension - LH	Fairlane, Torino	840-8470-L
	70-71	Trunk Floor Side Extension - RH	Fairlane, Torino	840-8470-R
4	70-71	Trunk Floor Extension to Tailamp Panel Brace - LH	Torino	920-8470-L
	70-71	Trunk Floor Extension to Tailamp Panel Brace - RH	Torino	920-8470-R



TRUNK GUTTER

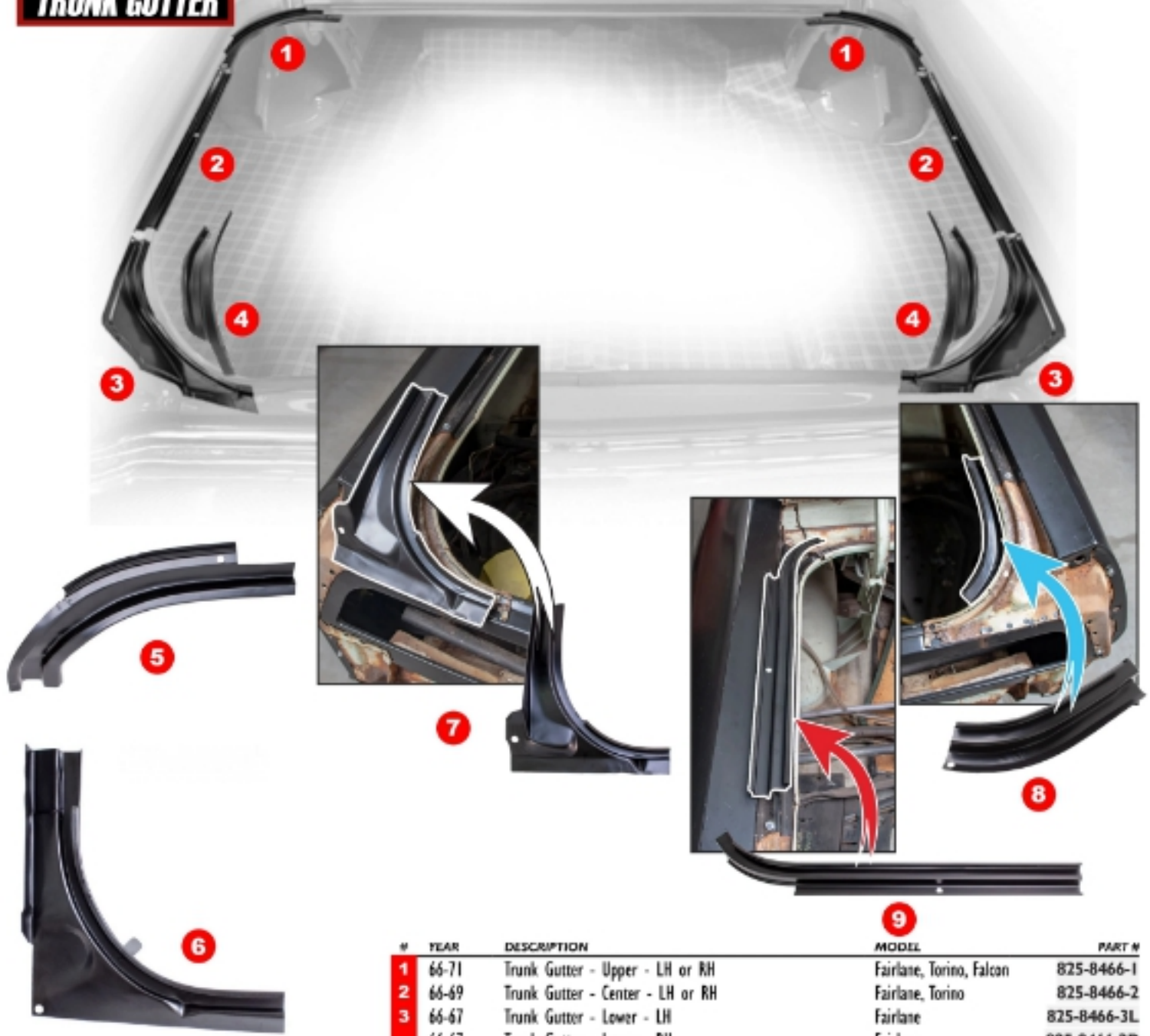

#	YEAR	DESCRIPTION	MODEL	PART #
1	66-71	Trunk Gutter - Upper - LH or RH	Fairlane, Torino, Falcon	825-8466-1
2	66-69	Trunk Gutter - Center - LH or RH	Fairlane, Torino	825-8466-2
3	66-67	Trunk Gutter - Lower - LH	Fairlane	825-8466-3L
	66-67	Trunk Gutter - Lower - RH	Fairlane	825-8466-3R
4	66-67	Trunk Gutter - Lower Quarter Support - LH	Fairlane	825-8466-4L
	66-67	Trunk Gutter - Lower Quarter Support - RH	Fairlane	825-8466-4R
5	68-69	Trunk Gutter - Upper - LH	Fairlane, Torino	825-8468-1L
	68-69	Trunk Gutter - Upper - RH	Fairlane, Torino	825-8468-1R
6	68-69	Trunk Gutter - Lower - LH	Fairlane, Torino	825-8468-3L
	68-69	Trunk Gutter - Lower - RH	Fairlane, Torino	825-8468-3R
7	70-71	Trunk Gutter - Lower Corner - LH	Torino	825-8470-1L
	70-71	Trunk Gutter - Lower Corner - RH	Torino	825-8470-1R
8	70-71	Trunk Gutter - Inside Lower Corner - LH	Fairlane, Torino	825-8470-3L
	70-71	Trunk Gutter - Inside Lower Corner - RH	Fairlane, Torino	825-8470-3R
9	70-71	Trunk Gutter - Upper/Center - LH	Fairlane, Torino	825-8470-L
	70-71	Trunk Gutter - Upper/Center - RH	Fairlane, Torino	825-8470-R
	62-71	Trunk Weatherstrip	Fairlane, Torino, Falcon	G-TS1075A



VISIT US ONLINE FOR THE MOST
 UP-TO-DATE PRICING AND SELECTION

CROSSRAIL



3



4

#	YEAR	DESCRIPTION	MODEL	PART #
1	66-67	Rear Crossrail	Fairlane	870-8466
2	68-69	Rear Crossrail	Fairlane, Torino	870-8468
3	66-69	Frame Rail to Rear Crossmember Bracket - LH	Fairlane, Torino	871-8466-L
	66-69	Frame Rail to Rear Crossmember Bracket - RH	Fairlane, Torino	871-8466-R
4	68-69	Rear Crossmember to Tail Panel Corner Reinforcement -LH	Fairlane, Torino	871-8468-L
	68-69	Rear Crossmember to Tail Panel Corner Reinforcement -RH	Fairlane, Torino	871-8468-R

FRAME RAIL



1



2



VISIT US ONLINE FOR THE MOST UP-TO-DATE PRICING AND SELECTION

#	YEAR	DESCRIPTION	MODEL	PART #
1	66-67	Rear Frame Rail Patch - LH	Fairlane	895-8466-1L
	66-67	Rear Frame Rail Patch - RH	Fairlane	895-8466-1R
2	68-69	Rear Frame Rail Patch - LH	Fairlane, Torino	895-8468-1L
	68-69	Rear Frame Rail Patch - RH	Fairlane, Torino	895-8468-1R



TAIL PANEL



VISIT US ONLINE FOR THE MOST

 UP-TO-DATE PRICING AND STOCKING



#	YEAR	DESCRIPTION	MODEL	PART #
1	68-69	Tail Panel	Fairlane, Torino	900-8468
2	70-71	Tail Panel	Torino	900-8470
2	66-69	Tail Panel to Crossrail Brace - LH	Fairlane, Torino	920-8466-1L
2	66-69	Tail Panel to Crossrail Brace - RH	Fairlane, Torino	920-8466-1R
3	68-69	Tail Panel Reinforcement - Upper - LH	Fairlane, Torino	920-8468-1L
3	68-69	Tail Panel Reinforcement - Upper - RH	Fairlane, Torino	920-8468-1R
4	68-69	Tail Panel Reinforcement - Lower - LH	Fairlane, Torino	920-8468-L
4	68-69	Tail Panel Reinforcement - Lower - RH	Fairlane, Torino	920-8468-R
5	66-67	Rear Body Panel	Fairlane	900-8466
6	66-67	Rear Body Panel Reinforcement Bracket - Small Inner - LH or RH	Fairlane	920-8466
7	66-67	Quarter to Taillamp Panel Filler Panel - LH	Fairlane	920-8466-L
7	66-67	Quarter to Taillamp Panel Filler Panel - RH	Fairlane	920-8466-R

TAIL PANEL



3



4



WWW
VISIT US ONLINE FOR THE MOST
UP-TO-DATE PRICING AND SELECTION



5



6

#	YEAR	DESCRIPTION	MODEL	PART #
1	68-69	Tailamp Bezels - Pair	Fairlane, Torino	X953-8468-P
2	66-69	Tailamp Seals - Pair	Fairlane, Torino	X954-8468-P
3	69	Exhaust Tips - 2.25" - Pair	Torino	X953-8469-P
	70-71	Exhaust Tips - 2.25" - Pair	Torino	X963-8470-P
4	68-71	Exhaust Hanger & Insulator Assembly	Fairlane, Torino	X963-8468-1P
5	66	Tailamp Bezel Reinforcement - LH or RH	Fairlane	953-8466
	67	Tailamp Bezel Reinforcement - LH or RH	Fairlane	953-8467
6	66-69	Trunk Exhaust Hanger	Fairlane, Torino	885-8466



SENDING UNIT



1



2



3



4



5



VISIT US ONLINE FOR THE MOST UP-TO-DATE PRICING AND SELECTION

N	YEAR	DESCRIPTION	MODEL	PART #
1	62-65	Gas tank Sending Unit - 5/16" Outlet	Fairlane	881-8462-5
2	66-69	Gas Tank Sending Unit - 3/8" Outlet	Fairlane	881-8468
3	70	Gas Tank Sending Unit - 3/8" Outlet	Fairlane, Torino	881-8466-3
4	70	Gas Tank Air Relief to Vent Tube Connector	Fairlane, Torino	891-8467
	62-70	Gas Cap - Ventted - w/o EEC	Fairlane, Torino	X888-1462
	66-70	Gas Cap - Ventted - w/o EEC	Falcon	X888-3958
	60-70	Gas Cap - Ventted - w/o EEC	Fairlane, Falcon, Ranchero	X888-8060
5	66-69	Filler Neck to Quarter Seal	Fairlane, Torino	R-FA164

WINDSHIELD

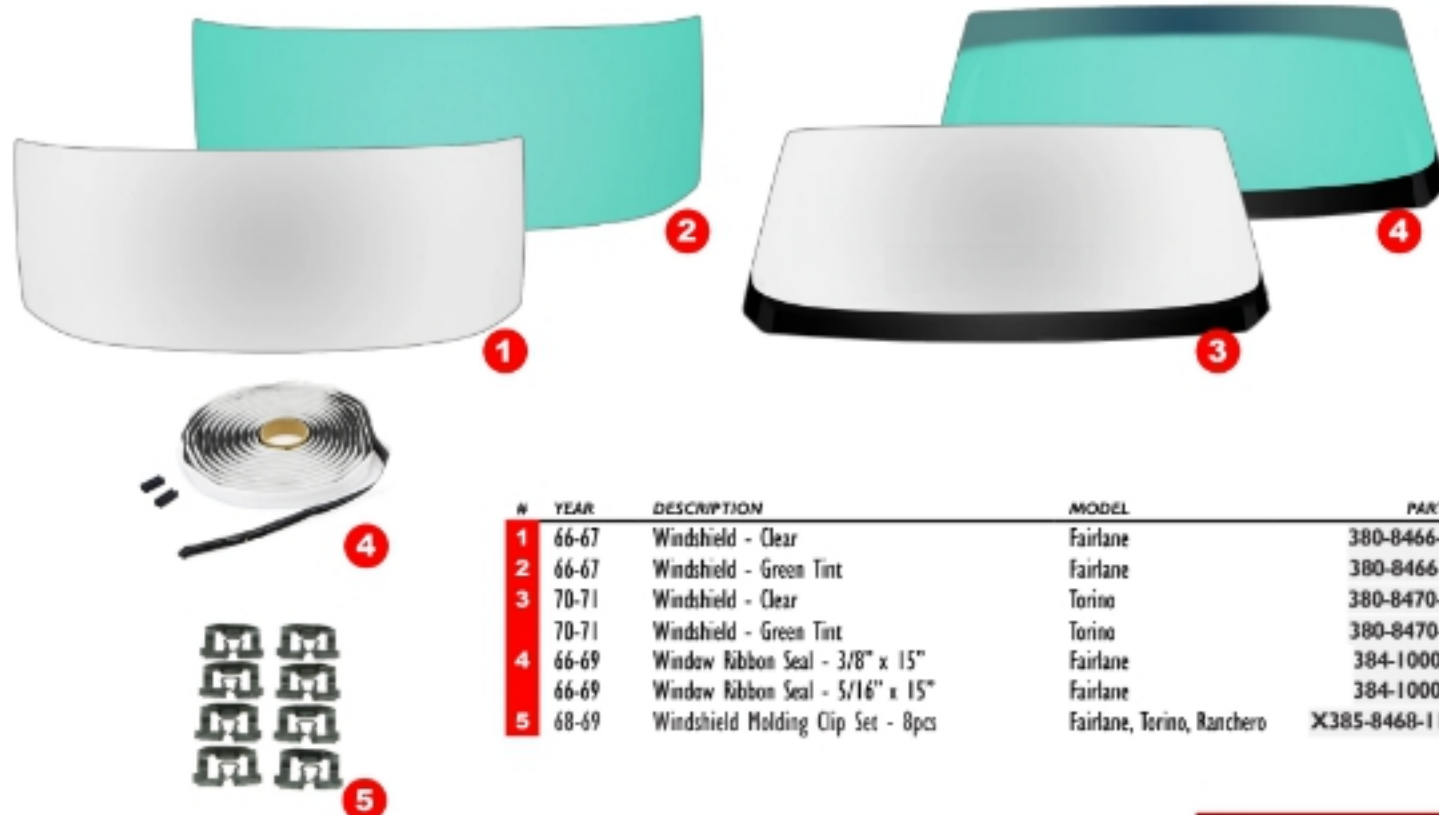

#	YEAR	DESCRIPTION	MODEL	PART #
1	66-67	Windshield - Clear	Fairlane	380-8466-C
2	66-67	Windshield - Green Tint	Fairlane	380-8466-T
3	70-71	Windshield - Clear	Torino	380-8470-C
	70-71	Windshield - Green Tint	Torino	380-8470-T
4	66-69	Window Ribbon Seal - 3/8" x 15"	Fairlane	384-1000-3
	66-69	Window Ribbon Seal - 5/16" x 15"	Fairlane	384-1000-5
5	68-69	Windshield Molding Clip Set - 8pcs	Fairlane, Torino, Ranchero	X385-8468-11S

BACK GLASS

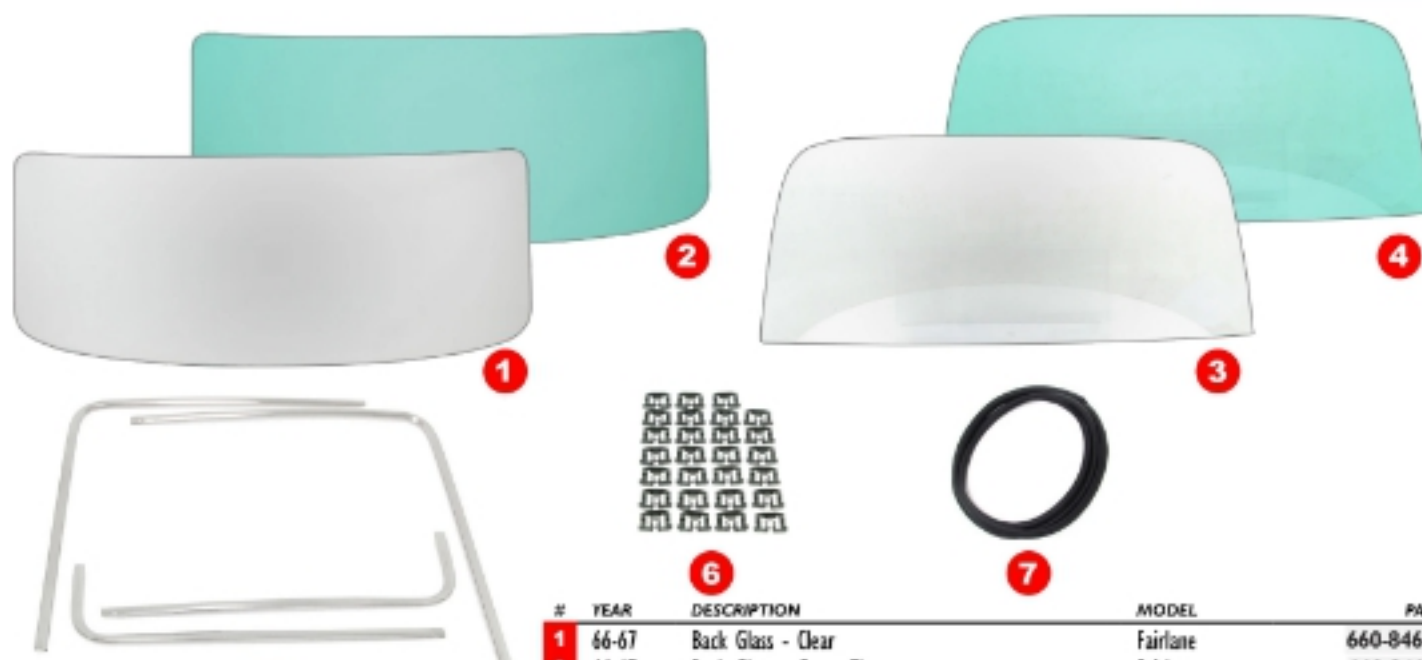

#	YEAR	DESCRIPTION	MODEL	PART #
1	66-67	Back Glass - Clear	Fairlane	660-8466-C
2	66-67	Back Glass - Green Tint	Fairlane	660-8466-T
3	70-71	Back Glass - Clear	Torino	660-8470-C
4	70-71	Back Glass - Green Tint	Torino	660-8470-T
5	68-69	Back Glass Molding Set - 4pcs	Fairlane, Torino	670-8468-S
6	68-69	Back Glass Molding Clip Set - 27pcs	Torino	X671-8468-2S
7	66-67	Rear Window Seal	Fairlane	G-WCRDB354S



VISIT US ONLINE FOR THE MOST UP-TO-DATE PRICING AND SELECTION





DOOR GLASS

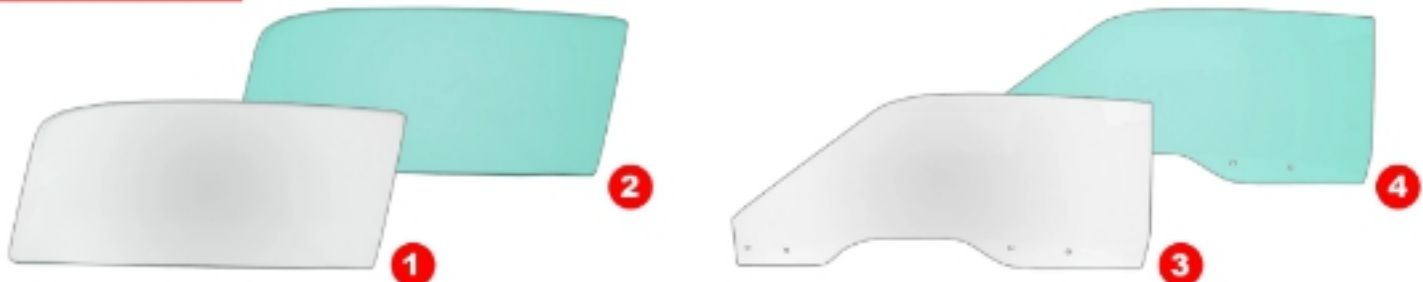

#	YEAR	DESCRIPTION	MODEL	PART #
1	66-67	Door Glass - Clear -LH	Fairlane	550-8466-CL
	66-67	Door Glass - Clear -RH	Fairlane	550-8466-CR
2	66-67	Door Glass - Green Tint -LH	Fairlane	550-8466-TL
	66-67	Door Glass - Green Tint -RH	Fairlane	550-8466-TR
3	70-71	Door Glass - Clear -LH	Torino	550-8470-CL
	70-71	Door Glass - Clear -RH	Torino	550-8470-CR
4	70-71	Door Glass - Green Tint -LH	Torino	550-8470-TL
	70-71	Door Glass - Green Tint -RH	Torino	550-8470-TR

VENT GLASS

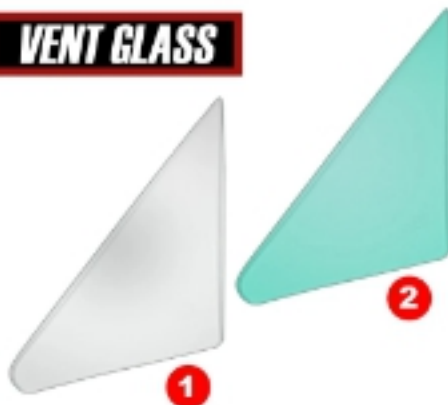

#	YEAR	DESCRIPTION	MODEL	PART #
1	66-67	Vent Glass - Clear -LH	Fairlane	560-8466-CL
	66-67	Vent Glass - Clear -RH	Fairlane	560-8466-CR
2	66-67	Vent Glass - Green Tint -LH	Fairlane	560-8466-TL
	66-67	Vent Glass - Green Tint -RH	Fairlane	560-8466-TR

QUARTER GLASS

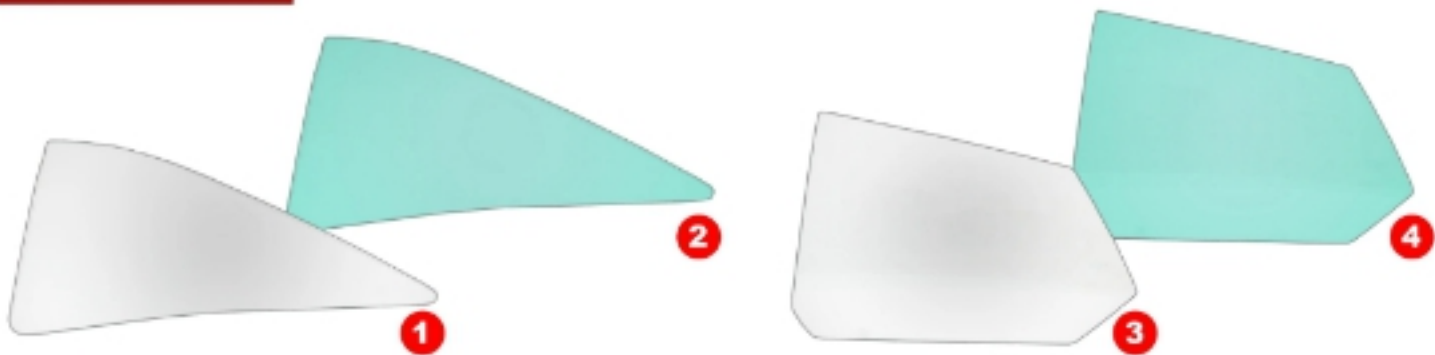

#	YEAR	DESCRIPTION	MODEL	PART #
1	66-67	Quarter Glass - Clear -LH	Fairlane	795-8466-CL
	66-67	Quarter Glass - Clear -RH	Fairlane	795-8466-CR
2	66-67	Quarter Glass - Green Tint -LH	Fairlane	795-8466-TL
	66-67	Quarter Glass - Green Tint -RH	Fairlane	795-8466-TR
3	70-71	Quarter Glass - Clear -LH	Fairlane, Torino	795-8470-CL
	70-71	Quarter Glass - Clear -RH	Fairlane, Torino	795-8470-CR
4	70-71	Quarter Glass - Green Tint -LH	Fairlane, Torino	795-8470-TL
	70-71	Quarter Glass - Green Tint -RH	Fairlane, Torino	795-8470-TR



VISIT US ONLINE FOR THE MOST

 UP-TO-DATE PRICING AND SELECTION

WINDOW CRANK HANDLE



#	YEAR	DESCRIPTION	MODEL	PART #
1	68-69	Window Crank Handle - w/o Knob	Fairlane, Torino, Falcon, Ranchero	X546-8068-68
2	73-74	Window Crank Handle - w/ Clear Knob	Torino, Ranchero	X546-4573
3	68-72	Window Crank Handle Knob - Black	Fairlane, Torino, Falcon, Ranchero	X546-8068-681A
4	68-72	Window Crank Handle Screw Cover - Brushed Aluminum	Fairlane, Torino, Falcon, Ranchero	X546-8068-682

VENT WINDOW HANDLE



#	YEAR	DESCRIPTION	MODEL	PART #
1	62-65	Vent Window Handle - LH	Fairlane, Falcon, Ranchero	X561-8060-L
	62-65	Vent Window Handle - RH	Fairlane, Falcon, Ranchero	X561-8060-R
2	66-67	Vent Window Handle - LH	Fairlane, Falcon, Ranchero	X561-8066-L
	66-67	Vent Window Handle - RH	Fairlane, Falcon, Ranchero	X561-8066-R
3	68-69	Vent Window Handle - LH	Fairlane, Torino, Falcon	X561-8068-L
	68-69	Vent Window Handle - RH	Fairlane, Torino, Falcon	X561-8068-R



VISIT US ONLINE FOR THE MOST UP-TO-DATE PRICING AND INVENTORY



MOLDING



#	YEAR	DESCRIPTION	MODEL	PART #
1	66-67	Drip Rail Molding Set - 2DR Hardtop	Fairlane	630-8466-P



#	YEAR	DESCRIPTION	MODEL	PART #
2	69	Sail Panel Emblems/Gills - 6pcs	Fairlane, Torino	X999-8469-7S

PARK LAMP



#	YEAR	DESCRIPTION	MODEL	PART #
1	64-65	Park Lamp Lenses - Amber - 25 Amber LED - LH or RH	Fairlane, Torino, Ranchero	X135-4666-D
2	68-69	Park Lamp Lenses - Pair	Fairlane, Torino, Ranchero	E-6869TLENS

SIDE MARKER

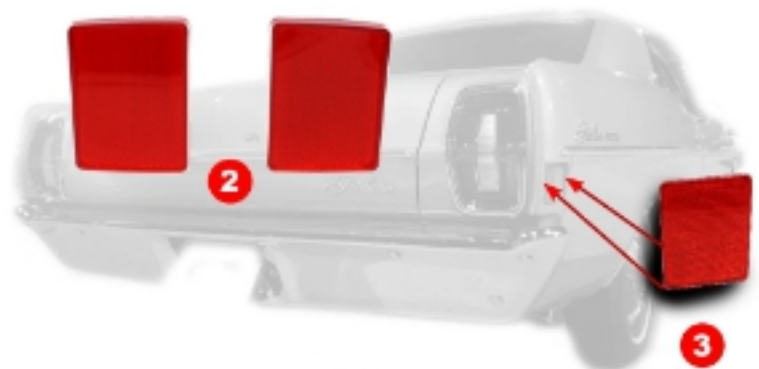

#	YEAR	DESCRIPTION	MODEL	PART #
1	70-71	Side Markers - front - 2 Req'd. - LH or RH	Torino, Ranchero	E-D0AZMARKER
2	68-69	Side Markers - Rear - Pair	Torino	E-C80Z1338063
3	68-69	Side Markers - Rear - Pair	Fairlane, Torino	E-C80Z1338065



HEADLAMPS



#	YEAR	DESCRIPTION	MODEL	PART #
1	65-72	RetroBright LED Forward Facing Headlight Kit - Classic White 3000K 4X6 - LOW-HIGH BEAM	Fairlane, Torino, Falcon, Ranchero	X149-HR465S-30L
2	65-72	RetroBright LED Forward Facing Light Bulb - Replacement Bulb - Bright White 5700K 4x6 - Standard H4 Wiring - High and Low Beam - 3 Pin	Fairlane, Torino, Falcon, Ranchero	X149-HR465S-57B
3	65-72	RetroBright LED Forward Facing Headlight Kit - Bright White 5700K 4X6 - HIGH-BEAM ONLY	Fairlane, Torino, Falcon, Ranchero	X149-HR465S-57H
4	65-72	RetroBright LED Forward Facing Headlight Kit - Bright White 5700K 4X6 - LOW-HIGH BEAM	Fairlane, Torino, Falcon, Ranchero	X149-HR465S-57L
5	65-72	RetroBright LED Forward Facing Headlight Kit - Classic White 3000K 5x7 - LOW-HIGH BEAM	Fairlane, Torino, Falcon, Ranchero	X149-HR558S-30
6	65-72	RetroBright LED Forward Facing Headlight Kit - Bright White 5700K 5x7 - LOW-HIGH BEAM	Fairlane, Torino, Falcon, Ranchero	X149-HR558S-57
7	65-72	LED 12V Headlamp - 5 3/4" High Beam - 3000K Classic White - LH or RH	Fairlane, Torino, Falcon, Ranchero	X149-HR575R-30H
8	65-72	LED 12V Headlamp Replacement Bulb - 5 3/4" Round or 4" x 6" / 165mm Rectangular High Beam - 3000K Classic White - LH or RH	Fairlane, Torino, Falcon, Ranchero	X149-HR575R-30HB
9	65-72	LED 12V Headlamp - 5 3/4" Low-High Beam - 3000K Classic White - LH or RH	Fairlane, Torino, Falcon, Ranchero	X149-HR575R-30L
10	65-72	LED 12V Headlamp Replacement Bulb - 5 3/4" Round Low-High Beam - 3000K Classic White - LH or RH	Fairlane, Torino, Falcon, Ranchero	X149-HR575R-30LB
11	65-72	LED 12V Headlamp - 5 3/4" Round High Beam - 5700K Bright White (Sold Each)	Fairlane, Torino, Falcon, Ranchero	X149-HR575R-57H
12	65-72	LED 12V Headlamp Replacement Bulb - 5 3/4" Round or 4" x 6" / 165mm Rectangular High Beam - 5700K Bright White - LH or RH	Fairlane, Torino, Falcon, Ranchero	X149-HR575R-57HB
13	65-72	LED 12V Headlamp - 5 3/4" Round Low-High Beam - 5700K Bright White - LH or RH	Fairlane, Torino, Falcon, Ranchero	X149-HR575R-57L
14	65-72	LED 12V Headlamp Replacement Bulb - 5 3/4" Round Low-High Beam - 5700K Bright White - LH or RH	Fairlane, Torino, Falcon, Ranchero	X149-HR575R-57LB
15	65-72	LED 12V Headlamp - 7" Round Low-High Beam - 3000K Classic White - LH or RH	Fairlane, Torino, Falcon, Ranchero	X149-HR700R-30
16	65-72	LED 12V Headlamp Replacement Bulb - 7" Round or 5" x 7" / 200mm Rectangular Low-High Beam - 3000K Classic White - LH or RH	Fairlane, Torino, Falcon, Ranchero	X149-HR700R-30B
17	65-72	LED 12V Headlamp - 7" Round Low-High Beam - 5700K Bright White - LH or RH	Fairlane, Torino, Falcon, Ranchero	X149-HR700R-57
18	65-72	LED 12V Headlamp Replacement Bulb - 7" Round or 5" x 7" / 200mm Rectangular Low-High Beam - 5700K Bright White - LH or RH	Fairlane, Torino, Falcon, Ranchero	X149-HR700R-57B



BODY HARDWARE



Image is for reference only. Actual part(s) will vary depending on application.

#	YEAR	DESCRIPTION	MODEL	PART #
1	66	Master Body Hardware Set - 365pcs	Fairlane	X225-8466-S
	66	Master Body Hardware Set - 394pcs	Ranchero	X225-8766-S
	66-67	Master Body Hardware Set - 322pcs	Falcon	X225-8066-S
	67	Master Body Hardware Set - 365pcs	Fairlane	X225-8467-S
	68	Master Body Hardware Set - 412pcs	Fairlane, Torino	X225-8468-S
	69	Master Body Hardware Set - 398pcs	Fairlane, Torino	X225-8469-S
	70	Master Body Hardware Set - 489pcs	Torino w/Hideaway Headlamps	X225-8470-1S
	70	Master Body Hardware Set - 487pcs	Torino Cobra	X225-8470-2S
	70	Master Body Hardware Set - 501pcs	Torino Standard	X225-8470-S
	71	Master Body Hardware Set - 489pcs	Torino w/Hideaway Headlamps	X225-8471-1S
	71	Master Body Hardware Set - 479pcs	Torino Cobra	X225-8471-2S
	71	Master Body Hardware Set - 491pcs	Torino Standard	X225-8471-S

MISC



#	YEAR	DESCRIPTION	MODEL	PART #
1	64-65	Wiper Switch Bezel	Falcon, Ranchero	X460-8064-2



#	YEAR	DESCRIPTION	MODEL	PART #
2	68-69	Power Steering Host Set - 4pcs	Fairlane, Torino, Ranchero	X397-8468-1S

#	YEAR	DESCRIPTION	MODEL	PART #
3	70-73	Back-up Light Switch - w/ Retainer	Fairlane	R-945
4	70-73	Back-up Light Switch	Fairlane	R-943
5	70-73	Back-up Light Switch Retainer	Fairlane	R-944

TOOLS



#	YEAR	DESCRIPTION	MODEL	PART #
1	65-69	Ignition Bezel Nut Tool	Fairlane, Falcon	TOOL-31
2	65-72	Door Panel Fastener Remover	Fairlane, Torino, Falcon, Ranchero	TOOL-34
3	65-72	Plugweld Filers	Fairlane, Torino, Falcon, Ranchero	TOOL-35
4	65-72	Plugweld Filers Replacement Copper Pad	Fairlane, Torino, Falcon, Ranchero	TOOL-36
5	65-72	PLastic Panel and Trim Removal Tool Set	Fairlane, Torino, Falcon, Ranchero	TOOL-37
6	65-72	Wiper Arm Removal Tool	Fairlane, Torino, Falcon, Ranchero	TOOL-39
7	65-72	Roller Tool	Fairlane, Torino, Falcon, Ranchero	TOOL-44



VISIT US ONLINE FOR THE MOST

 UP-TO-DATE PRICING AND SELECTION

This Auto Metal Direct hat is the original Flexfit cap with poly-weave spandex to assure you get the perfect fit.

HATS



#	DESCRIPTION	PART #
1	AMD Black Flexfit Cap	AMDHAT-2

INSRUCIONAL VIDEOS

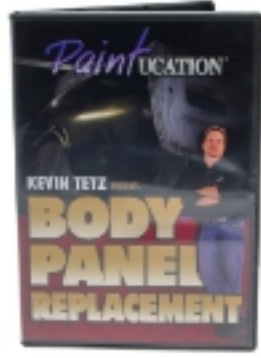

- 1
- 2
- 3
- 4
- 5
- 6
- 7
- 8
- 9
- 10
- 11

#	YEAR	DESCRIPTION	MODEL	PART #
1	62-72	Body Panel Replacement - Kevin Tetz DVD	Fairlane, Torino, Falcon, Rancho	KTP-2
2	62-72	Color Sanding & Buffing - Kevin Tetz DVD	Fairlane, Torino, Falcon, Rancho	KTP-3
3	62-72	Body Shop Basics - Kevin Tetz DVD	Fairlane, Torino, Falcon, Rancho	KTP-4
4	62-72	Dodge Dart Quarter Panel Replacement	Fairlane, Torino, Falcon, Rancho	CHP-1
5	62-72	After Paint	Fairlane, Torino, Falcon, Rancho	CHP-2
6	62-72	Installing front Sheet Metal	Fairlane, Torino, Falcon, Rancho	CHP-3
7	62-72	Door Skinning 101	Fairlane, Torino, Falcon, Rancho	CHP-4
8	62-72	Auto Body MIG Welding	Fairlane, Torino, Falcon, Rancho	CHP-5
9	62-72	Panel Perfect	Fairlane, Torino, Falcon, Rancho	CHP-6
10	62-72	Full Floor Install	Fairlane, Torino, Falcon, Rancho	CHP-7
11	62-72	Installing Patch Panels	Fairlane, Torino, Falcon, Rancho	CHP-8



 VISIT US ONLINE FOR THE MOST
 UP-TO-DATE PRICING AND SELECTION





800.638.1703

1550 MELISSA CT. CORONA, CA 92879

performanceonline.com

DISC BRAKE CONVERSIONS



5% OFF
USE PROMO CODE
F100AMD

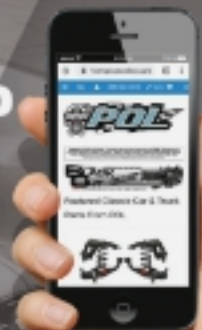

Applications

- 48-52 F1
- 53-56 F100
- 57-60 F100
- 61-64 F100

**F100 Mustang II IFS
Suspension Kits**



ALUMINUM FUEL TANKS



ALUMINUM RADIATORS



DISC BRAKES



STEERING



POWER BRAKES



SUSPENSION AND CHASSIS



SUSPENSION AND CHASSIS



SUSPENSION AND CHASSIS



ALUMINUM RADIATORS



9" REARENDS



FUEL TANKS ALUMINUM & OEM

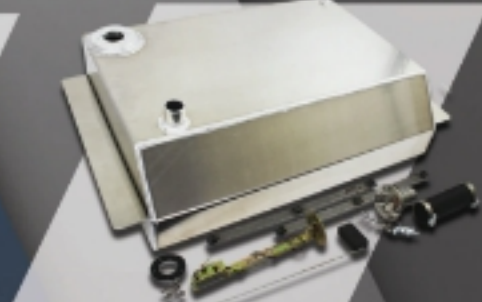

FiTech **Fuel Injection**

1964-68 M
EFI SYSTEM
EACH PACKAG





+

FUE

FUEL INJECTION KIT

 **FITECHEFI.COM**

 **(951) 340-2624**

 **SALES@FITECHEFI.COM**



MUSTANG 600 HP M TOTAL PACKAGE E COMES COMPLETE WITH:



FUEL HOSE KIT

+

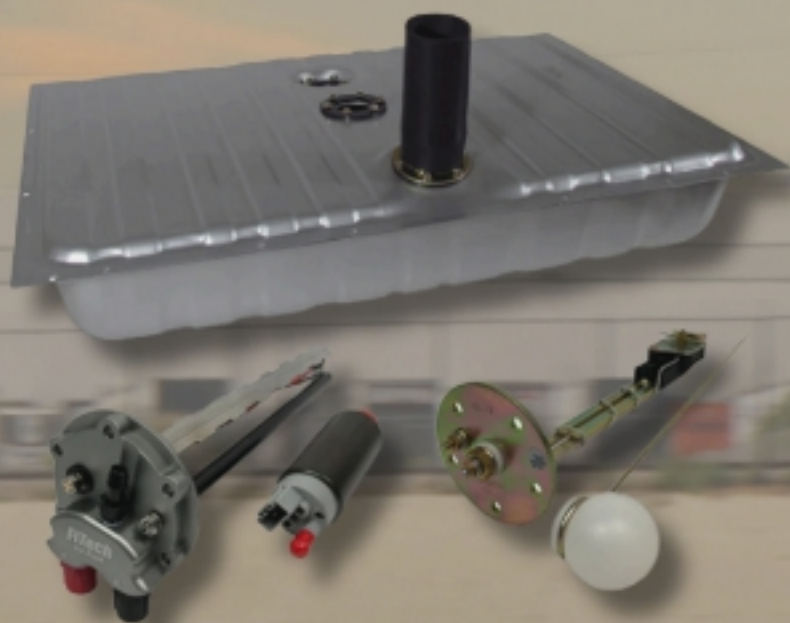

FUEL TANK KIT



ADDITIONAL PACKAGES AVAILABLE:





Complete Ford 9 Rear Ends Replacement and Upgrade Parts

Direct fit Ford 9 Rear Ends

All new construction
Laser-Cut, Jig-Welded Brackets
Ships UPS to Any Location
Built-to-Order
Many Options Available Including:
- Custom Widths
- Powdercoating
- Flipped Perches

Common Builds:
450HP Street/Strip Rear End \$2315
1,000HP Drag Racing Rear End \$2529

GM10 Bolt, GM12 Bolt, and Dana 60 Parts

Ring and Pinions
Posi, Lockers, Spools, Open Differentials
Bearing Kits
Axles Shafts
5 / 6 / 8 Lug Conversions
Disc and Drum Upgrades
Billet and Standard Covers
Pinion Yokes



QUICKPERFORMANCE.COM

515.232.0126

REVOLT

AUTO PAINT

HIGH QUALITY AUTO PAINT AND SUPPLIES AT REASONABLE PRICES, SHIPPED RIGHT TO YOUR DOOR. PERFECT FOR YOUR RESTORATION OR CUSTOM PROJECT. GREAT CUSTOMER SERVICE WITH ACTUAL HUMANS WHO KNOW PAINT. GIVE US A CALL OR VISIT THE WEBSITE FOR ANY INFORMATION.

WWW.REVOLTAUTOPAINT.COM

1-855-5-REVOLT



MAX GUNDY'S COE IN "LOYALTY BLUE"

THE ULTIMATE PERFORMANCE



**N
E N
DRIV**



48'-79' FOR

865-940-1503

1001 EPCO DRIVE • D

PERFORMANCE TRUCK CHASSIS

FOR BOTH STREET AND TRACK

NOLIMIT
ENGINEERING
BUY IT, SHOW IT, RACE IT



PERFORMANCE TRUCK CHASSIS - COIL-OVER OR AIR RIDE

BEST BODY PARTS ON
THE BEST CHASSIS 

ANDRIGE, TN 37725

NOLIMIT.net